







The Cypress range has been designed to set the standard and offers great value for money holiday homes.

This thoughtful design not only offers excellent value for money at a fraction of the price, it also offers many of the homely features you would expect in your own home, the Cypress range has proven to be a popular choice for our distributors due to its spacious rooms & contemporary designed furniture. This range features a wide variety of models from a 21ft to a 35ft in both 10 & 12ft options! to 'This range features a wide variety of models from a 23ft 1 bed to a 38ft 4 bedroom caravan,

yet regardless of the size they all have a common theme, the wide front bay window that floods light on the modern interior to create bright homely spaces, large open-plan living areas and generously sized bedrooms, vaulted ceilings and domestic style interior doors throughout.

The lounge and dining areas combine to create an extensive array of seating options that can be specified to reflect your individual tastes. A stylish and well equipped domestic style kitchen has good storage, worktop space, a dedicated position for a microwave oven and the option of a built in fridge freezer all finished with stylish MDF doors. Well-proportioned bedrooms and large family shower room containing a walk in full height shower, plus generous storage throughout adds to the comprehensive specification of the Cypress range.



-  Fridge space
-  Cupboard/storage
-  Seating
-  Carpet
-  Vinyl floor

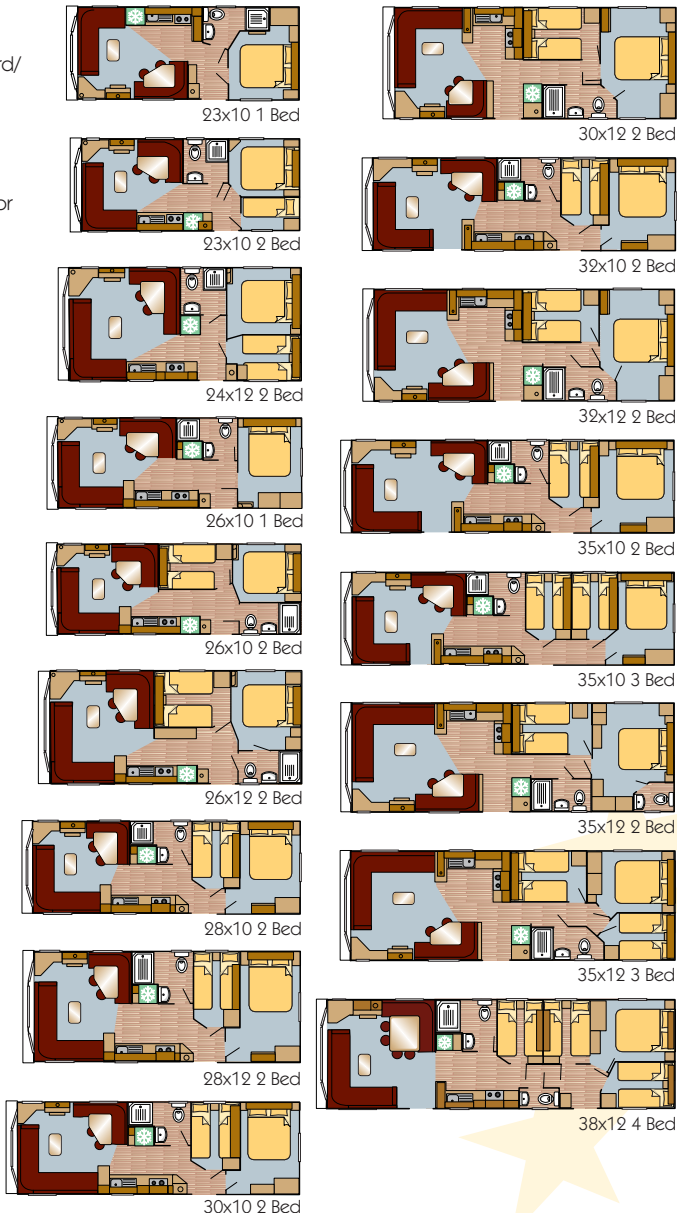

Standard Features

- uPVC single glazed windows and aluminium door(s)
- Pantiled roof
- Exterior aluminium is planked wood grain effect
- Insulated hot and cold water pipe work
- Under floor Insulation
- Vaulted plywood ceilings throughout
- Modern gas fire
- Integrated 600 wide cooker with electronic ignition
- Integrated cooker hood
- Microwave space
- Space for fridge
- Domestic style interior doors and handles
- Metal action fold out bed to lounge seating
- MDF doors to lounge and kitchen
- Generous storage throughout
- Thermostatic shower mixer
- Carbon monoxide detector and smoke alarm fitted

Options Available

- uPVC double glazed windows and door(s)
- Pre galvanised chassis
- Gas central heating
- Electric heaters
- Extra insulation
- Fridge or small fridge freezer
- Table and 4 chairs in lieu of fixed dinette
- Environmental green exterior
- Padded headboards



Europa Caravans Limited
 Unit 3 Wyke Works, Hedon Road
 Hull, HU9 5NL
 Tel: (01482) 226682
 Fax: (01482) 900022
 Email: info@europacaravans.com
www.europacaravans.com

The Model shown on this leaflet has the following extra's - Double glazing, central heating, integrated fridge freezer, MDF doors to bedrooms, padded headboards and table and 4 chairs

The information displayed in this leaflet is correct at the time of printing, in the possible event of supply shortages or alternative materials, alterations may have to be made to the models. In this event any changes may be obtained from your dealer. All colours have been matched as close as printing techniques permit, variations may occur when compared to the actual fabrics.

All props such as televisions, DVDs, crockery etc. are purely for display purposes only and not included.

